



1 - WATERPROOFING

Make sure to waterproof (polyurethane based joint sealant) any joints or cavities to watertight before installing a weather shield sarking as per manufacturer's specifications.



2 - BORDERS

Install 27x27mm border angle using appropriate fasteners to structure block work, studs, etc...

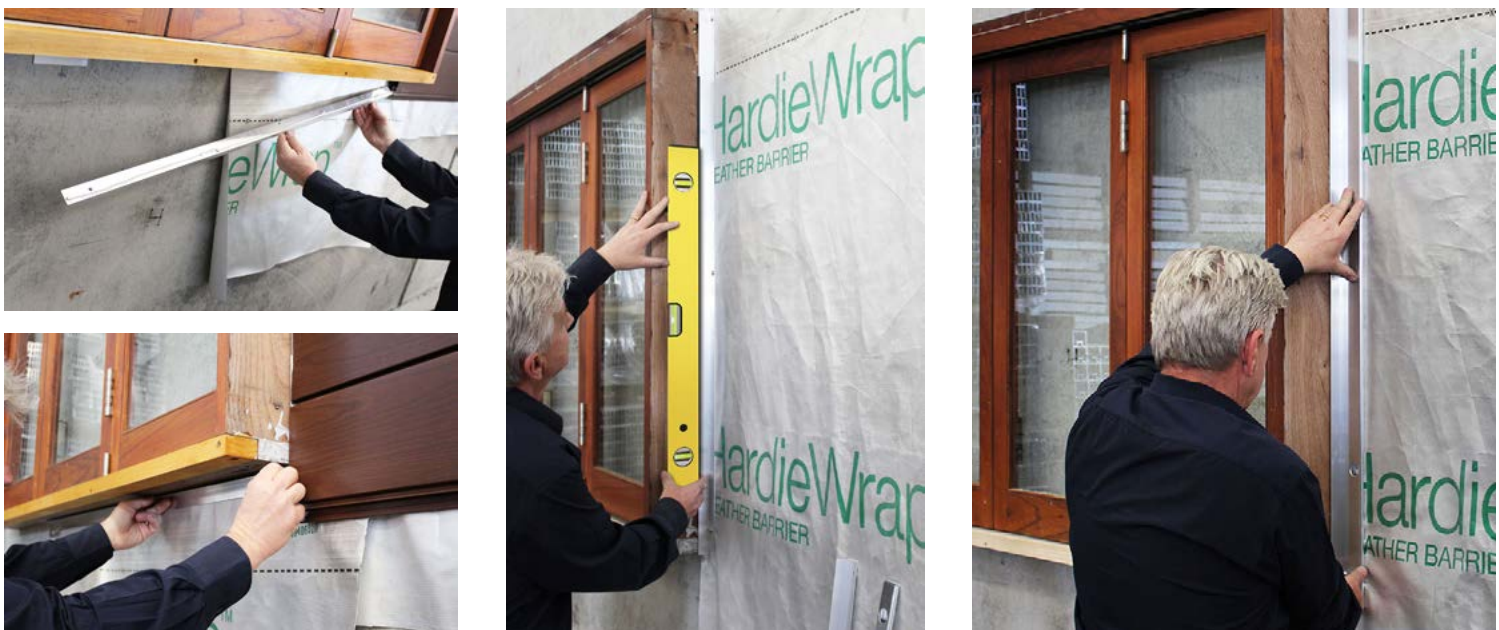

All images shown are for illustration purposes only.





3 - TOP HATS/BATTEMS

Fix off top hat or battens to level and plumb with max. spacing of 600mm using appropriate fasteners.



4 - CLADDING

Fix cladding to battens using a 10 gauge x 12mm Tek screw with rubber washer. Leave minimum of 2mm between cladding edge and angle for waterproofing.



All images shown are for illustration purposes only.





5 - SEALS

Seal joints between cladding edge & angle using polyurethane based joint sealant.



6 - RIVETS

Fix off 50x25mm finishing angle, 20mm channel or suitable flashing with 1/8" rivets or Tek screws and touch up.



All images shown are for illustration purposes only.

